

KELTIC S E R I E S



Providing the widest selection of quality vinyl and aluminum window & door products.

International Window Corporation
IWVC
Your Window to the World®

KELTIC DOOR SERIES

At International Window, quality is our trademark. That is why we leave nothing to chance. Today, we bring you the all new Keltic Door Series. This series is available in large sliding, pocket doors, 90° corners and custom configurations. All of the door panels easily collapse together, giving you the option to create an opening as large as you can imagine. With quick lead times, quality manufacturing, and a name like International Window... the Keltic Door Series can fill any opening.



Discover the advantages of our Keltic Door Series

1 to 4 Track One Piece Extrusion – extruded in one piece with the ability to attach more tracks to add an unlimited number of panels. This gives you the ability to stack as many panels as you want. The possibilities are only up to your imagination. Every unit will utilize a stainless steel running track that our **Roll-Xtreme** roller will glide smoothly on every time the door is opened. All stainless steel running tracks are completely removable and replaceable. Our track system gives you the peace of mind with stainless steel...yet allows you to replace a unit if it ever becomes damaged.

Hardware – we took every detail into consideration. Even our handle is subtle yet functional. The handle color is satin brushed nickel, and is recessed flat with the panel. This gives the door that very sleek and modern appeal yet functions extremely well. The lock is a multipoint locking system to provide added security. All doors come with a standard external keyed locking system.

Roll-Xtreme – features 14 precision stainless steel 5mm ball bearings. These Swiss bearings enable the large panels to glide effortlessly and handle a larger sized panel with ease. Quite simply the Roll-Xtreme is the best on the market.

Colors – we offer 3 stock finishes. **Class 1 Dark Bronze Anodized**, **Clear Class 1 Anodized** and **White Paint**. We are proud to offer these three colors standard to keep lead times at a minimum. Additional finishes available by request.

Framing – all doors will come standard in a block frame.

Spacer – we offer two colors: **Dark Bronze** or **Silver** finish spacers.

Glass – the doors come standard with an energy efficient 1" glass unit utilizing a spectrally selective Low-E coating. Glass units are manufactured with 1/4" tempered glass and a dual seal technology offering the most efficient unit with the promise of dependability for years to come.

Above Grade Sills Pans (Standard 3/4" Full Pan System) – we offer a wide variety of drainage pans with custom heights available. And with a Stainless Steel Cap...there is nothing to worry about in the future.



Pull Handle – Flush mount easy grip rotating pull handle in the lead stile

MOTORIZED DOOR SYSTEM

Standard Features

- Motion Sensor
- Wireless Wall Switch
- Remote Control
- Battery Backup
- Home Automation Interface

Automation Control Options

- Touch Screen
- Wireless Wall Switch
- Secure External Keypad



Available in Motorized Door System – specifically designed to open large doors with the touch of a button. This product is intended to work with a variety of door sizes, styles, and configurations. With automatic doors, homeowners can easily take advantage of their stunning views and incredible weather.

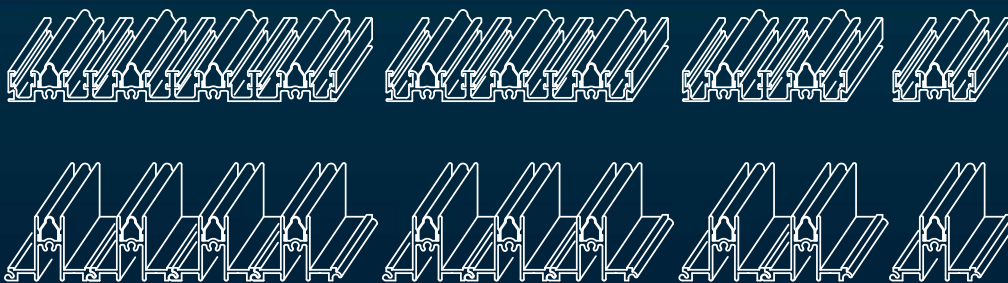

1 to 4 Track One Piece Extrusion (Up to 4 tracks, all in one extrusion) – extruded in one piece with the ability to attach more tracks to add an unlimited numbers of panels. The opportunities are endless. This gives you the ability to stack as many panels as you want. The possibilities are only up to your imagination.



KELTIC 7800 Multi-Slide Door System



XXXO

MULTI-SLIDE CONFIGURATIONS AND SIZES

Our Multi-Slider allows you to configure any number of rolling and fixed glass panels to meet your specific design requirements.



KELTIC 7800 MULTI-SLIDE DOOR SYSTEM

KEY FEATURES

- Door systems are designed using heavy-duty Architectural Grade Aluminum
- Heads, jams and surface sills are available in 1,2,3,4 tracks. All tracks are linkable to increase the number of tracks
- Offered with surface mount sill or recessed sill. Recessed available in either 1" or 1 1/2"
- Available in staggered hidden track system
- Stainless steel tracks standard
- Recessed locking handle with multi point locking system
- All Stainless Steel Roll-Xtreme 3" diameter wheels with heavy duty Swiss Bearings
- Stainless steel fasteners
- Available in Motorized Door System with the touch of a button to open large doors

Surface Mount System

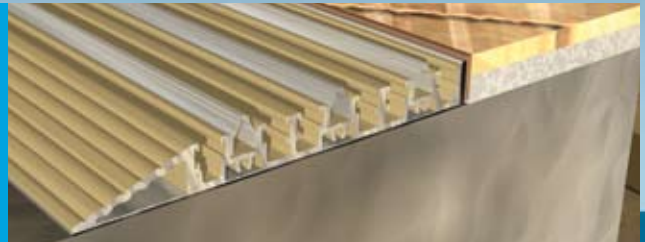

Available in Staggered Hidden Track System

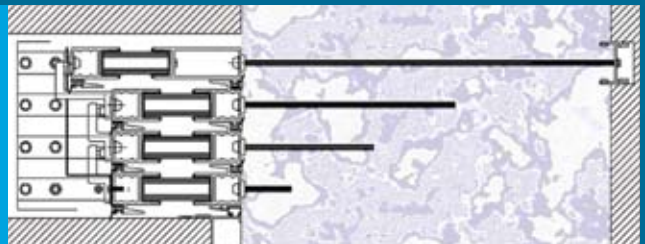

Recessed System

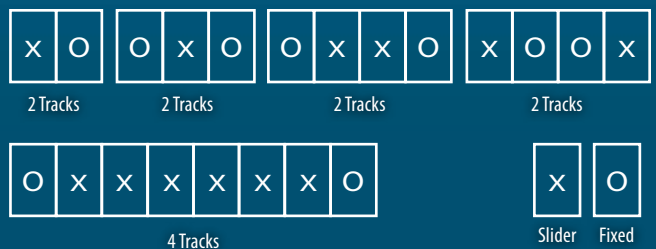
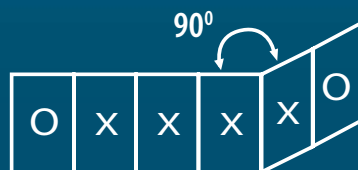

KELTIC 7800 Pocket Door System



XXX 90° XXX

KELTIC 7800 POCKET DOOR SYSTEM

With the *Pocket Door* ... all of the door panels easily collapse into the wall giving an appearance of a totally open space.



KELTIC 7800 POCKET DOOR SYSTEM

KEY FEATURES

- All pocket door panels are hidden in the walls when the door is open
- Door systems are designed using heavy-duty Architectural Grade Aluminum
- Heads, jambs and surface sills are available in 1,2,3,4 tracks. All tracks are linkable to increase the number of tracks
- Offered with surface mount sill or recessed sill. Recessed available in either 1" or 1 1/2"
- Available in staggered hidden track system
- Removable stainless steel tracks standard
- Flush mount easy grip rotating pull handle in the lead stile
- Recessed locking handle with multi point locking system
- All Stainless Steel Roll-Xtreme 3" diameter wheels with heavy duty Swiss Bearings
- Stainless steel fasteners
- Available in Motorized Door System with the touch of a button to open large doors

Sizes – in an effort to make these doors the finest in the industry...we have engineered the 7800 Series with all the necessary components to make our product the best. Our standard panels range from 3' to 6' wide and up to 12' tall. The possibilities are endless... and with the ability to get custom sizes...there is no opening we can't fill.



Slider Fixed Pocket



KELTIC Sliding Glass Door

KELTIC 7620 Series LC 25 | KELTIC 7622 Series LC 35 | KELTIC 7720 Series CW 50



OX

KELTIC SLIDING GLASS DOOR

The Keltic sliding door offers a slim design with a strong, rigid patio door that creates the perfect passageway between your home and the outdoors.



Upgrade to Roll-Xtreme for better performance

- 3 inch diameter wheels with heavy duty Swiss Bearings
- Features 14 precision stainless steel 5mm ball bearings
- Easy gliding, time after time



**Residential
Patio Door Roller**

**Keltic 7600
Door Roller**

Roll-Xtreme Roller
Precision Bearing
(Stainless Steel Roller)

Features	7620 FIN or 7680 Block	7622 FIN or 7682 Block	7722 FIN or 7782 Block
Rating	LC25	LC35	CW50
4 1/2" Frame	OPT	STD	STD
5 7/8 Frame	STD	OPT	OPT
1 5/8 Sill Height (5 7/8 wide)	STD	N/A	N/A
2" Sill Height (4 1/2 wide)	N/A	STD	N/A
3" Sill Height (4 1/2 wide)	N/A	OPT	STD
Multi Point Hardware standard	STD	STD	STD
1 13/16 Roller	STD	N/A	N/A
3" Roll-Xtreme Roller	OPT	STD	STD
Standard Low-E Glass	STD	N/A	N/A
Standard 1/4" Low-E Glass	OPT	STD	STD

KELTIC SLIDING GLASS DOOR

KEY FEATURES

- 4 1/2" or 5 7/8" Nail Fin or Block Frame
- 1 7/8" Steel Roller or Optional Stainless Steel Roll-Xtreme 3 inch diameter wheels with heavy duty Swiss Bearings
- Stainless steel tracks standard
- 1 5/8", 2" and 3" Sill
- Recessed locking handle with multi point locking system



Slider



Fixed

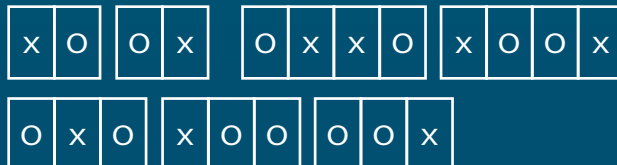

KELTIC 7080 Hinged Door

Keltic 7080 Hinged Door



1 panel door

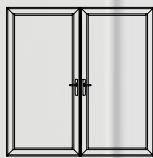

2 panel doors

Key Features

- Frames: 1" x 4½"
- Panels: 2¼"
- Clear Anodized and Bronze Anodized finishes standard. Other finishes available
- Thermally-Broken
- One inch O.A. glazing
- Out-Swing
- Stainless steel multi-point hardware standard
- Durable hardware available in several finishes
- Heavy-duty five knuckle hinges



Technical Data

AAMA Rating: DP-50

One Panel Door and Two Panel Doors

Water: **7.5 p.s.f.** (out-swing)

U-Factor: **0.37** (out-swing)

Forced Entry: **300 lbs.**

For Specifications, Details, and Testing Data go to www.intlwindow.com

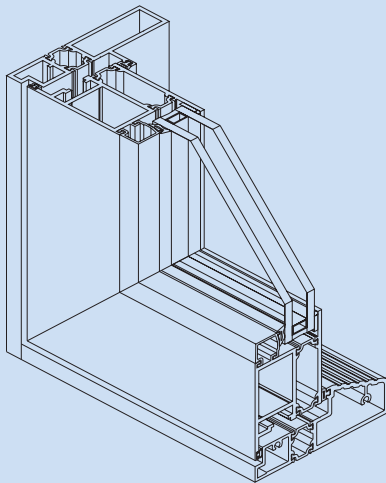
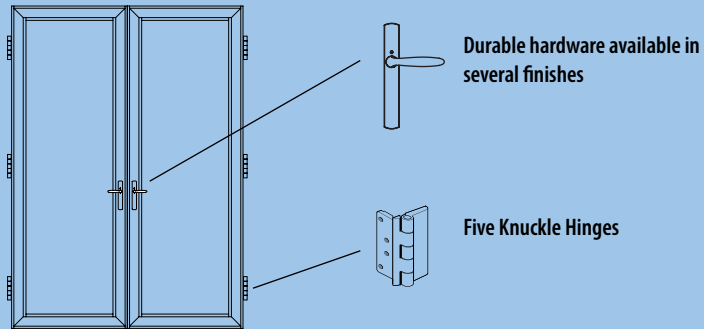

Keltic 7080 Hinged door

Looking for performance and value to match your next project? Look no further than our Keltic 7080 Hinged door. The Keltic 7080 Door offers high performance and outstanding value for residential housing units and nonresidential commercial projects. The out-swing model is available with 1 panel or 2 panel operation. The 7080 panel is 2¼" thick with a 1" x 4½" frame and features a fully thermally-broken system to improve thermal performance. The 7080 door also includes multi-point hardware and dead bolt for maximum security.



Hardware

Multi-point Hardware — complete with stainless steel handle with a one inch dead bolt for maximum security. *(Optional keyed locks are available)* Hinges available to match door finish.



KELTIC 7223 Hinged Windows

Keltic 7223 Hinged Windows

Available:

Casements • Awnings • Hoppers • Fixed windows

Test Results

AAMA	DP-50
NFRC	U factor as low as 0.37
SHGC	as low as 0.20

Key Features:

- Push out Casement
- Push out Awning
- Pull down hopper
- Thermally broken frame with state of the art "MLPTM" fill and debridge process
- 1" glazing standard
- All have standard cam locks
- Friction hinges
- 2 1/2" frame and sash
- 1" fin offset
- Foam weatherstripping throughout
- Each Corner reinforced with two 5/16" thick corner keys that are "staked" in place
- 1/2" glass penetration
- Combination units are available in single perimeter frame
- Outside glazing standard. Inside glazing available



The New Keltic 7223 Thermally Broken Frame

The Keltic 7223 Series windows feature the AZON's MLP™ (Mechanical Lock Profile) thermal break total design system. It offers the best balance of energy efficiency and high strength for aluminum fenestration products used in the most demanding climates and conditions. These windows also feature the heavy duty corner keys to reinforce the mitered corners.



The Keltic 7223 Series Commercial Hinged Windows

Casements • Awnings • Hoppers • Fixed windows

The Keltic 7223 Series Commercial Hinged Windows utilize top-of-the-line "Heavy Duty 4-bar Friction Hinges" which ensures smooth operation. These windows also feature the AZON's MLP™ (Mechanical Lock Profile) thermal break total design system to improve thermal performance. When energy efficiency and optimal ventilation are a priority, the 7223 is perfect for your next residential or commercial property project.

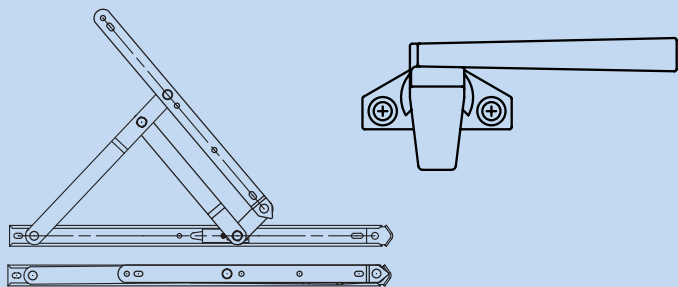

Heavy Duty 4-bar Friction Hinges

The Heavy Duty 4-bar Friction Hinges have been designed to be used for commercial projects requiring relatively heavy window sections and ensure smooth operation.



Cam Handle (Casement)



Cam Handle (Hoppers)



Cam Handle

The Cam Handle is designed to provide long and trouble-free service. Two-piece strike design includes a polyester insert to provide a smooth operation and reduce wear. It will increase both security and weather seal tightness.



UPGRADE TO ENERGY SHIELD XTREME

Cooler in the Summer

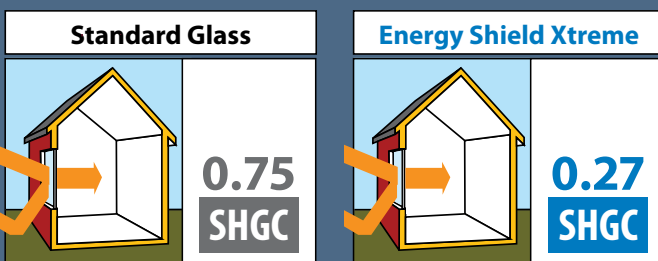

Thanks to its special low-emissivity (low-e) coating, a door made with Energy Shield Xtreme glass allows 65 percent less heat from the sun to enter your home than a window with ordinary glass. That can reduce summer cooling costs by up to 25 percent. Solar Heat Gain Coefficient (SHGC) is a measure of how much solar heat is transmitted through the glass. A lower SHGC means less summer heat.

Warmer in the Winter

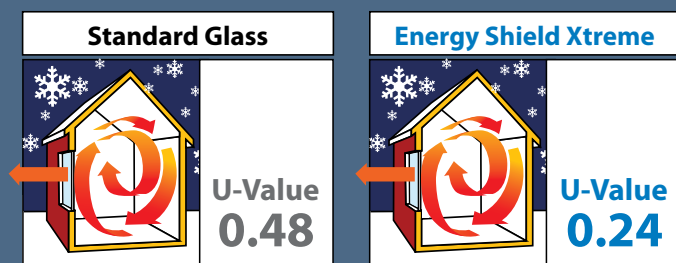

Furnace heat lost through your doors is at its peak on winter nights. When your doors are made with Energy Shield Xtreme glass instead of ordinary glass, this heat loss is cut nearly half, meaning lower heating bills.

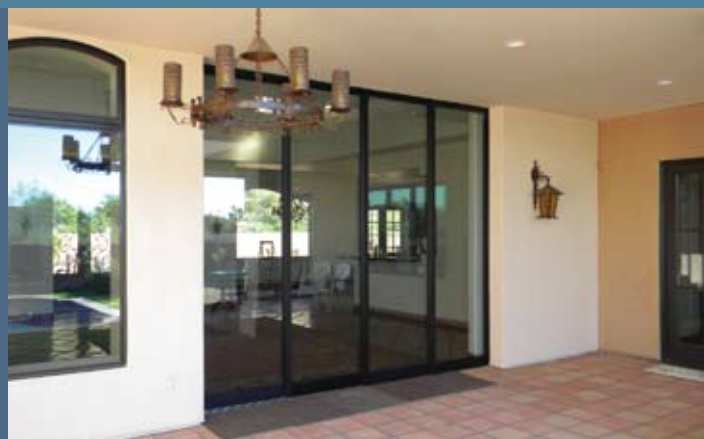

Note: Tdw-ISO represents potential fading damage caused by both UV and visible light. It is considered by the U.S. Department of Energy and the International Standards Organization (ISO) to be a more accurate barometer of fade resistance than UV transmittance alone. All comparisons are center of glass based on an insulating unit containing 3/4" insulating units; two 1/8" (3mm) glass lights and a 1/2" (12mm) air-filled space for the standard clear insulating glass and argon gas-filled space for the Energy Shield Xtreme insulating glass. Actual glass performance may differ due to glass thickness, gas fill and glass to frame ratio.

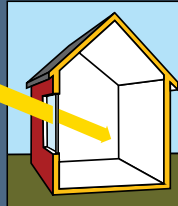
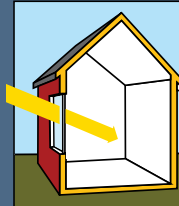

Comfortable, Abundant Light

Standard Glass	Energy Shield Xtreme
	
Visible Light 81%	Visible Light 64%

Energy Shield Xtreme glass has a proprietary solar control low-e coating that blocks almost 3/4 of the sun's heat energy while transmitting abundant natural light.

Fade Protection

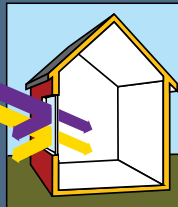
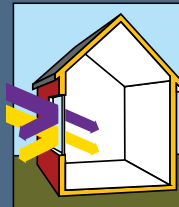
Standard Glass	Energy Shield Xtreme
	
Ultraviolet Energy 58%	Ultraviolet Energy 6%
DamageWeighted Transmittance 0.74	DamageWeighted Transmittance 0.43

The solar control, low-e coating of Energy Shield Xtreme glass blocks ultraviolet (UV) energy, which is traditionally associated with fading, 90% more effectively than ordinary glass. However, a more complete measure of fading resistance called "damageweighted transmittance," shows that Energy Shield Xtreme glass also protects your fabrics, furniture and carpets from fading caused by visible light.

Energy Shield Xtreme, the latest innovation in windows & doors and the next generation of energy-efficient glass, is a new high-performance coating that gives homeowners enhanced solar control, outstanding winter thermal performance, daylight management, and preferred neutral aesthetics – all at an affordable price.

Solar Heat Gain Coefficient (SHGC) represents the solar heat gain through the glass relative to the incident solar radiation. It is equal to 86% of the shading coefficient.

Figures may vary due to manufacturing tolerances. All tabulated data are based on the National Fenestration Rating Council (NFRC) methodology, using the Lawrence Berkeley National Laboratory's Window software.



Southern California
1.800.477.4032

Visit our website at www.intlwindow.com